



**THE COMPLETE DUCT SOURCE**  
**Quality—Delivery—Service—Design—Price**

**US Duct—BALL JOINTS**

Steel galvanized ball joints provide flexibility in ducts serving moving cutter heads or other moving equipment. Thus, duct can swing through an arc while maintaining exhaust flow in the line. Available in 3" through 12" diameter.

Swivel Ball Joint connects Spiral Pipe or Flex hose to allow the rotation of a dust or fume hood. Ideal for CNC Router & other machines with traversing heads. Ball Joints with TWO proper installation collars - one collar to fit ductwork and a second EXTENDED COLLAR to connect to flex hose allowing proper and free rotation of Ball Joint.

Swivel Ball Joint connects Spiral Pipe or Flex hose to allow the rotation of a dust or fume hood. Ideal for CNC Router & other machines with traversing heads.

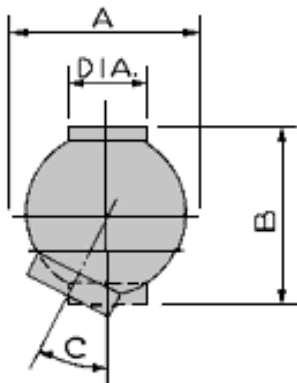

DIA"	A"	B"	C	LBS
3	5 3/8	4 3/4	23 DEGREES	1.00
4	7 1/2	6 1/2	23 DEGREES	1.75
5	9	7 7/8	27 DEGREES	2.50
6	10 3/8	8 7/8	27 DEGREES	3.00
7	10 3/8	7 7/8	15 DEGREES	4.00
8	13	11	27 DEGREES	7.00
9	14 5/8	11 1/4	27 DEGREES	8.00
10	14 3/4	12	22 DEGREES	9.00
12	16 1/2	12 1/4	20 DEGREES	10.00