

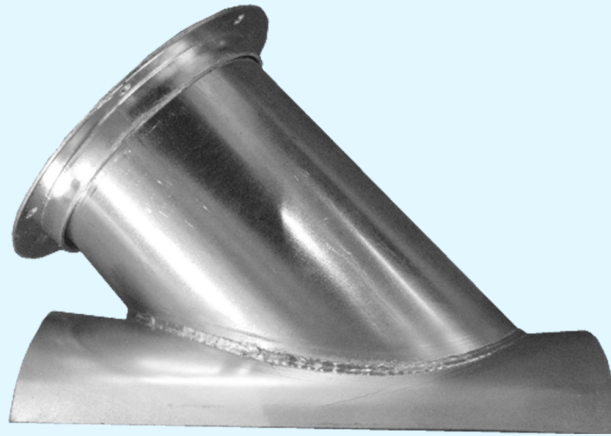

In-Cut Branch

- Standard at 45° and available in 10-90° upon request
- Rolled Lip 3-20", 22 and 24", Angle Ring ends 3-74"
- Material Types: Galvanized, Stainless Steel, and Carbon Steel



Leg to base are always fully MIG welded here at US Duct

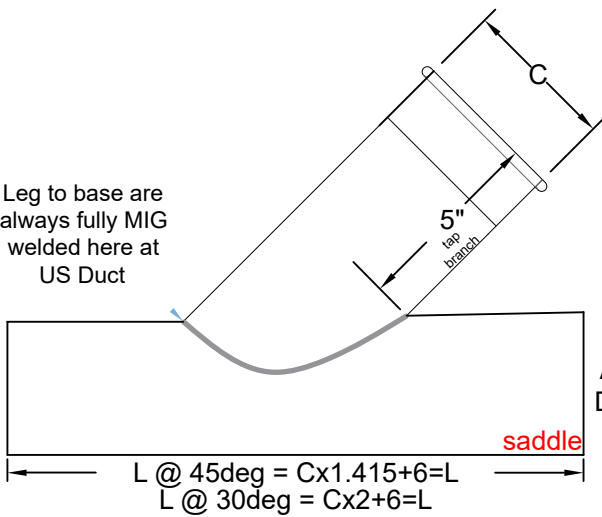

Leg to base are always fully MIG welded here at US Duct

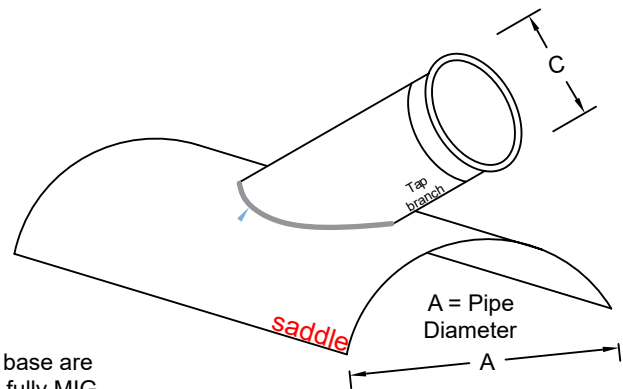

All branches are 18 gauge or heavier.	
Saddles will be:	3-6" 18 gauge
A = Pipe	7-12" 16 gauge
Diameters	12" and up 14 gauge
Flat Saddle plates will be 14 gauge	

In-Cut Branches at 90 degree and on a Flat

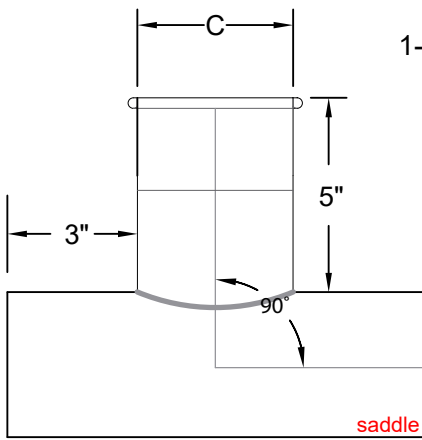

Saddle side Length.
1-3" depending on C to A diameter,
or tap on to the pipe ratio.

Example:
10 to 10 will only be around 1"
and
4 to 10 will have around 3"

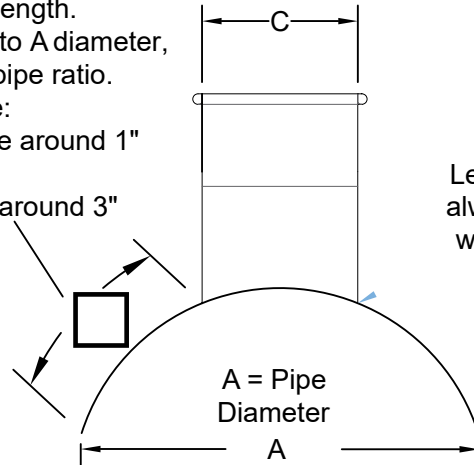

Leg to base are
always fully MIG
welded here at
US Duct

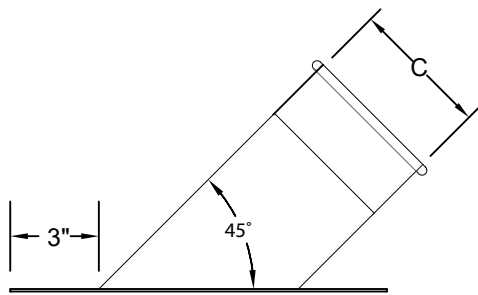

Flat Plate

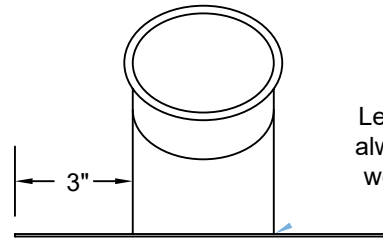

Leg to base are
always fully MIG
welded here at
US Duct

Standard at 45 degree and available in 10-90 degree upon request
Rolled Lip 3-20" 22 and 24"
Angle ring ends 3-74"

Available in Galvanized, Stainless Steel and Carbon Steel

All branches are 18 gauge or heavier.	
Saddles will be:	3-6" 18 gauge
A = Pipe	7-12" 16 gauge
Diameters	12" and up 14 gauge
Flat Saddle plates will be 14 gauge	